

MdB= 1800 Nm - MdG= 2600 Nm

Ingombro Rotazione 98 mm

Esecuzione Codice 46 Allungamento Standard La=110 mm	Tubo d6+S 60x3 - β max 33° 76,2x2,41 – β max 25°
--	--

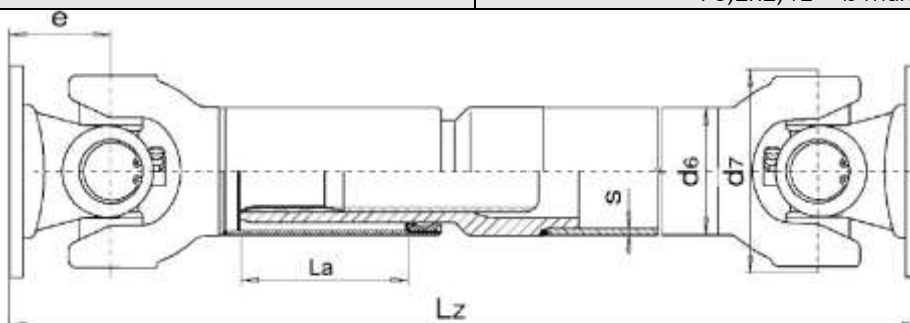

Flangia	L
DIN 90	450
DIN 100	450
DIN 120	450
SAE1300	450
SAE1400	450
KV120	442

Esecuzione Codice 56 Alto Allungamento La=250 mm	Tubo d6+S 60x3 - β max 33° 76,2x2,41 – β max 25°
--	--

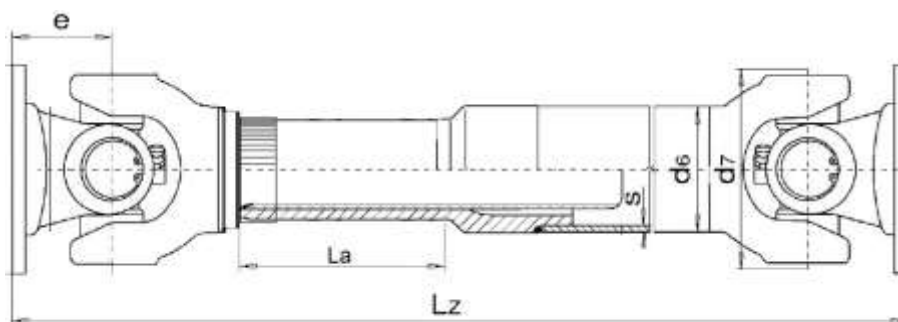

Flangia	L
DIN 90	610
DIN 100	610
DIN 120	610
SAE1300	610
SAE1400	610
KV120	602

MdB= 1800 Nm - MdG= 2600 Nm

Ingombro Rotazione 98 mm

Esecuzione Codice 44 - Scorrevole corta

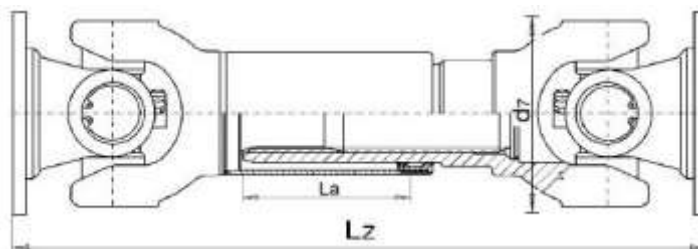

Flangia - β max 25°	Lz minima con e=46	Lz minima con e=58	La
DIN 90	234	258	20
DIN 100	234	258	20
DIN 120	234	258	20
SAE 1300	234	258	20
SAE 1400	234	258	20
KV/XS120		258	20

Esecuzione Codice 48 - Fissa

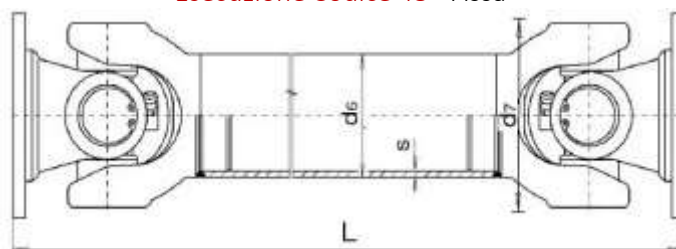

Flangia	L minima	Tubo
DIN 90	252	60x3 - β max 33° / 76.2x2.41 - β max 25°
DIN 100	252	60x3 - β max 33° / 76.2x2.41 - β max 25°
DIN 120	252	60x3 - β max 33° / 76.2x2.41 - β max 25°
SAE 1300	252	60x3 - β max 33° / 76.2x2.41 - β max 25°
SAE 1400	252	60x3 - β max 33° / 76.2x2.41 - β max 25°
KV/XS120	268	60x3 - β max 33° / 76.2x2.41 - β max 25°

Esecuzione Codice 314 - giunto semplice

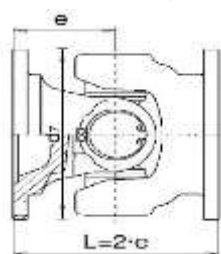

Esecuzione Codice 7675 - giunto doppio

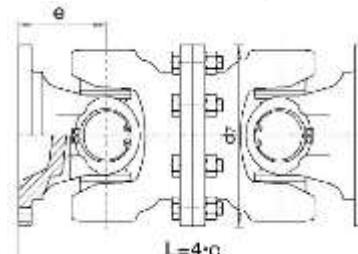

Flangia	L	L
DIN 90 / DIN100 / DIN120 / SAE1300 / SAE1400	116	232

MdB= 1800 Nm - MdG= 2600 Nm

Ingombro Rotazione 98 mm

Esecuzione Codice 315 - giunto doppio

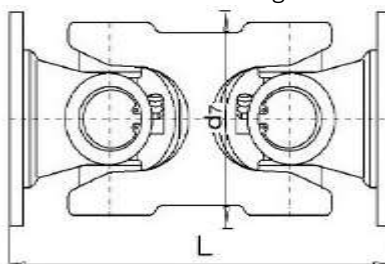

Flangia	L con e=46 - β max 25°	L con e=58 - β max 33°
DIN 100	162	186
DIN 120	162	186
SAE 1300	162	186
SAE 1400	162	186

Esecuzione Codice 26 Scorrevole a mozzo La=110mm	Tubo d6+S 60x3 / 76.2x2.41

Esecuzione Codice 36 Scorrevole a mozzo alto allungamento La=250mm	Tubo d6+S 60x3 - β max 33° 76,2x2,41 - β max 25°

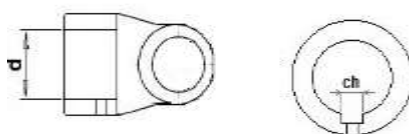

d. H7	Chiavetta	Lz min. La=100	Lz min. La= 250
24÷38	8÷12	464	650
40	12	586	716

MdB= 1800 Nm - MdG= 2600 Nm

Ingombro Rotazione 98 mm

Esecuzione Codice 34 - Scorrevole corta

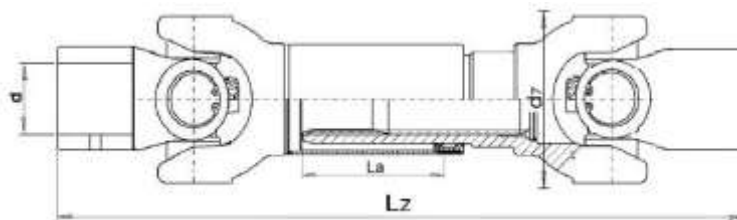

Flangia - β max 25°	Lz minima	La
24÷38	264	20
40	330	20

Esecuzione Codice 38 - Fissa a mozzo

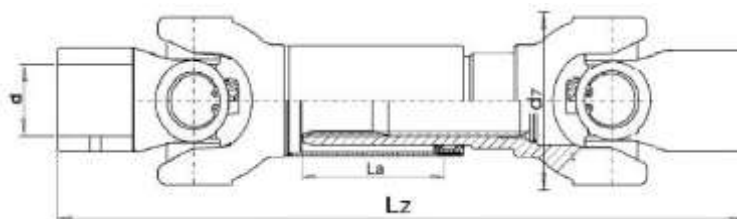

Flangia	Lz minima	Tube
24÷38	282	60x3 - β max 33° / 76.2x2.41 - β max 25°
40	348	60x3 - β max 33° / 76.2x2.41 - β max 25°

Esecuzione Codice 214 - giunto semplice a mozzo

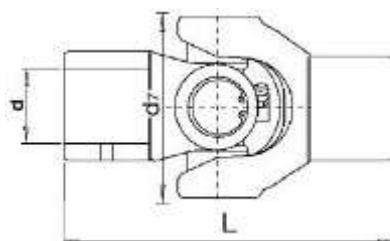

Flangia - β max 25°	L
24÷38	146
40	196

Esecuzione Codice 315 - giunto doppio ad H

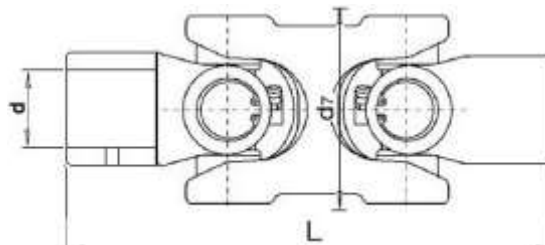

Flangia - β max 25°	L
24÷38	200
40	266