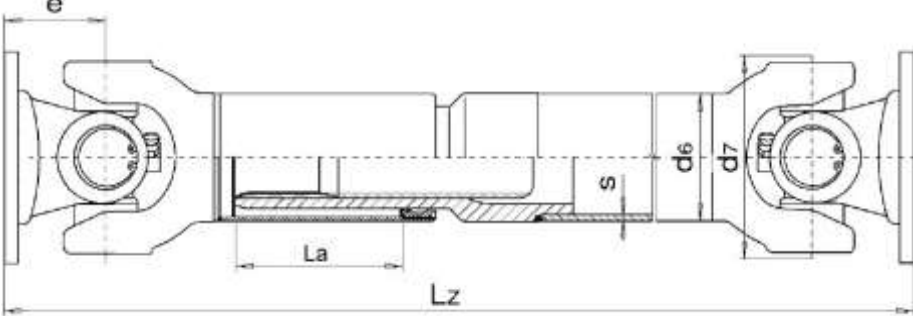
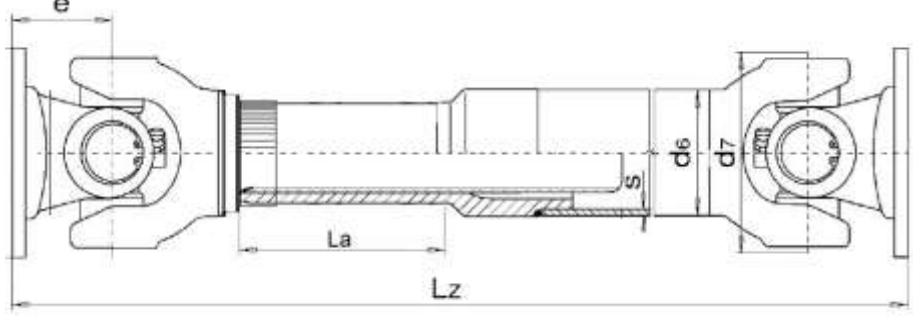

MdB= 600 Nm - MdG= 1100 Nm

Ingombro Rotazione 80 mm

<p>Esecuzione Codice 46 Allungamento Standard La=100 mm</p>	<p>Tubo d6+S 50,8x2,41 β max 25°</p>
	
<p>Flangia DIN 75 / DIN90 / SAE1100</p>	<p>L 360</p>

<p>Esecuzione Codice 56 Alto Allungamento La=250 mm</p>	<p>Tubo d6+S 50,8x2,41 β max 25°</p>
	
<p>Flangia DIN 75 / DIN90 / SAE1100</p>	<p>L 545</p>

MdB= 600 Nm - MdG= 1100 Nm

Ingombro Rotazione 80 mm

Esecuzione Codice 44 - Scorrevole corta

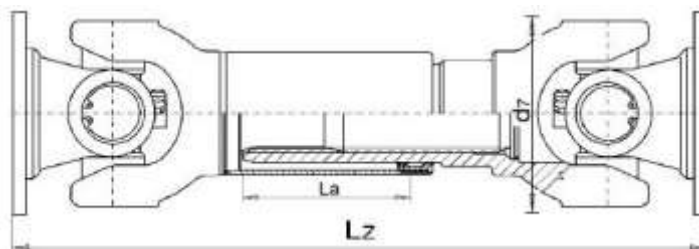

Flangia - β max 25°	Lz minima	La
DIN 75 / DIN90 / SAE1100	210	25

Esecuzione Codice 48 - Fissa

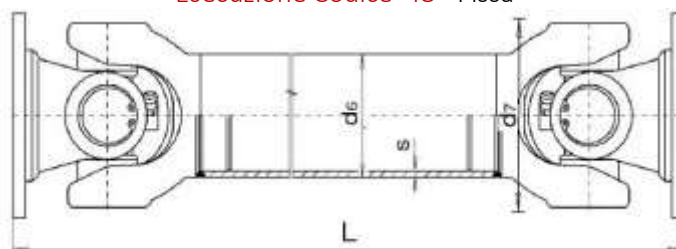

Flangia - β max 25°	L minima	Tubo
DIN 75 / DIN90 / SAE1100	185	50,8x2,41

Esecuzione Codice 314 - giunto semplice

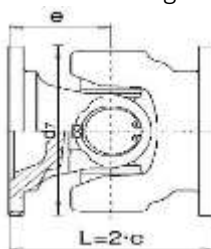

Flangia - β max 25°	L
DIN 75 / DIN90 / SAE1100	84

Esecuzione Codice 7675 - giunto doppio

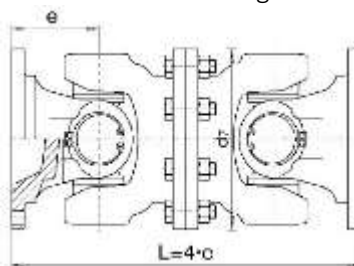

Flangia - β max 25°	L
DIN 75 / DIN90 / SAE1100	168

Esecuzione Codice 7675 - giunto doppio

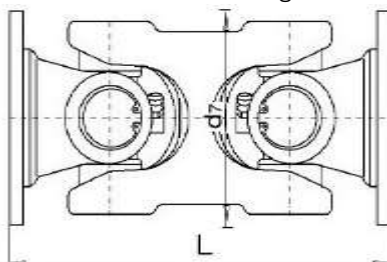

Flangia - β max 25°	L
DIN 75 / DIN90 / SAE1100	141

Esecuzione Codice 26
Scorrevole a mozzo La=100mm

Tubo d6+S 50,8x2,41
 β max 25°

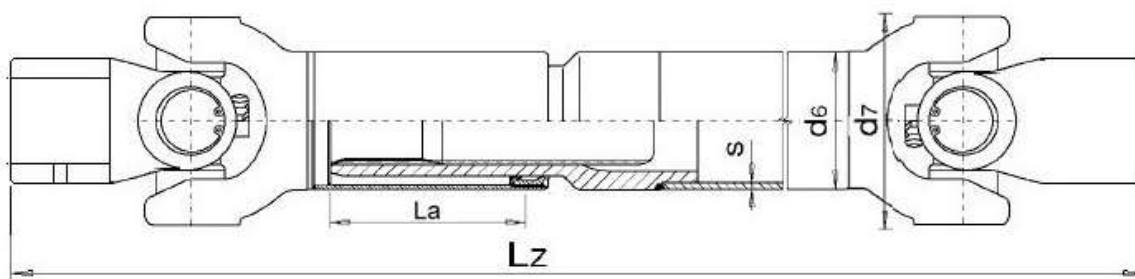

Esecuzione Codice 36
Scorrevole a mozzo alto allungamento La=250mm

Tubo d6+S 50,8x2,41
 β max 25°

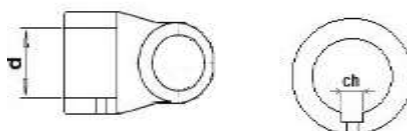
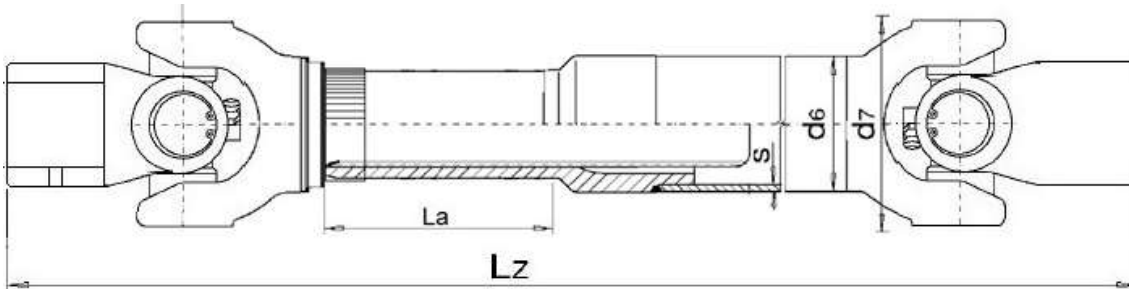

d. H7	Chiavetta	Lz min. La=100	Lz min. La= 250
24÷35	8÷10	405	590

MdB= 600 Nm - MdG= 1100 Nm

Ingombro Rotazione 80 mm

Esecuzione Codice 34 - Scorrevole corta

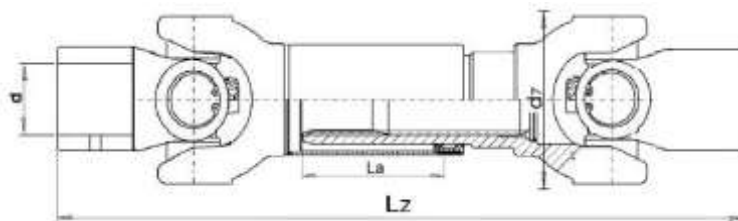

Flangia - β max 25°	Lz minima	La
24÷35	250	20

Esecuzione Codice 38 - Fissa a mozzo

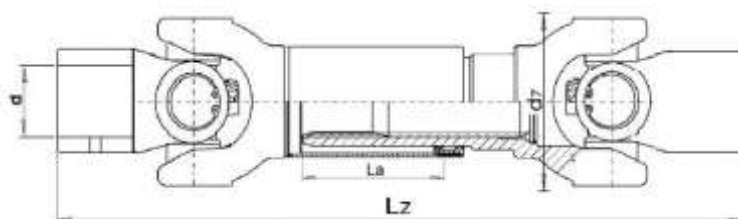

Flangia - β max 25°	Lz minima	Tubo
24÷35	230	50,8x2,41

Esecuzione Codice 214 - giunto semplice a mozzo

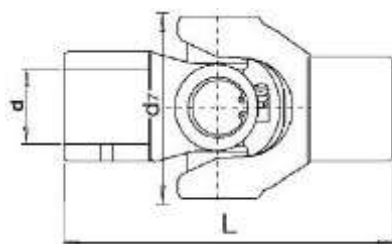

Flangia - β max 25°	L
24÷35	131

Esecuzione Codice 315 - giunto doppio ad H

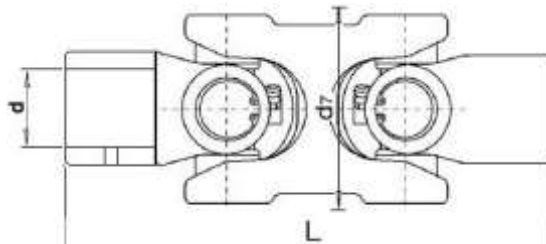

Flangia - β max 25°	L
24÷35	188